

SERIES OF TENSILE STRENGTH TEST FIXTURES

to test flatwise tensile strength and tensile adhesion properties according to ASTM C297, ASTM D3354, ASTM D1623B, EN 1607, EN 2243-4, DIN 53292.

Two types of fixtures are available

1. TH113 type for samples up to 100x100 mm
2. TH113-327 type for samples from 100x100 mm.

TH113 Type

Single-axis and double-axis versions for samples up to 100x100 mm

The fixture consists of one pair of loading block carriers and one pair of insert loading blocks. Carriers are available as a single-axis version (TH113-GT-Km10 and TH113-GT-M16) and a double-axis version (TH113-2Axe-GT).

Both carriers are suitable for all insert loading blocks.

A test specimen is bonded to the face of insert blocks that are then pulled apart.

Standard couplings:	Af159, Af20 or Af318. Further couplings on request
Max. load:	20 kN for TH113-GT-Km10 carrier 50 kN for TH113-GT-M16 carrier 10 kN for TH113-2Axe-GT carrier
Carrier and inserts:	Steel, nickel-plated
Temperature range:	-70 ... +350°C
Scope of delivery:	1 pair of carriers / 1 pair of inserts. Carrier and insert loading blocks should be ordered separately.

Item no.:	ASTM C297	ASTM D3354	ASTM D1623B	EN 1607	EN 2243-4	DIN 53292	Insert block size:	Weight each:
Carriers								
TH113-GT-Km10 / TH113-GT-M16	x				x			0.78 kg
TH113-2Axe-GT		x	x	x		x		1.30 kg
Insert blocks								
TH113-E50-25.4x25.4	x		x				25.4x25.4 mm	0.58 kg
TH113-E50-50x50				x	x	x	50x50 mm	0.71 kg
TH113-E50-50.8x50.8	x						50.8x50.8 mm	0.72 kg
TH113-E50-76.2x76.2	x						76.2x76.2 mm	0.98 kg
TH113-E50-100x100		x		x			100x100 mm	1.31 kg

Carriers



TH113-GT-Km10 / TH113-GT-M16



TH113-2Axe-GT

Insert blocks



TH113-E50-50x50



TH113-E50-100x100

Examples for TH113

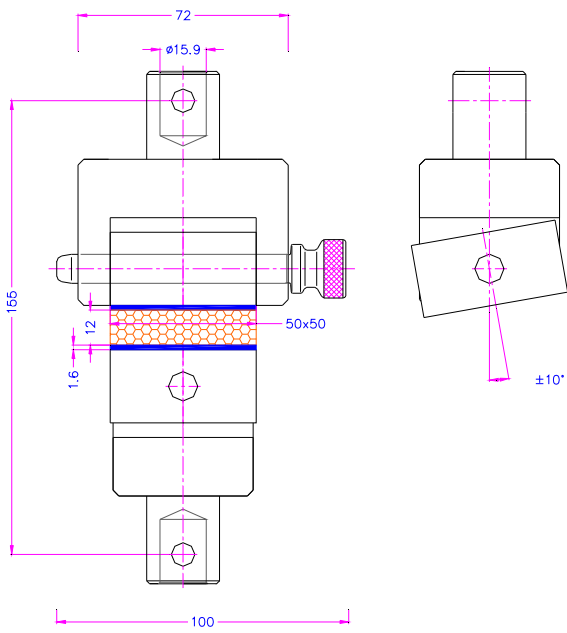

TH113-GT + TH113-E50-50x50 EN2243-4

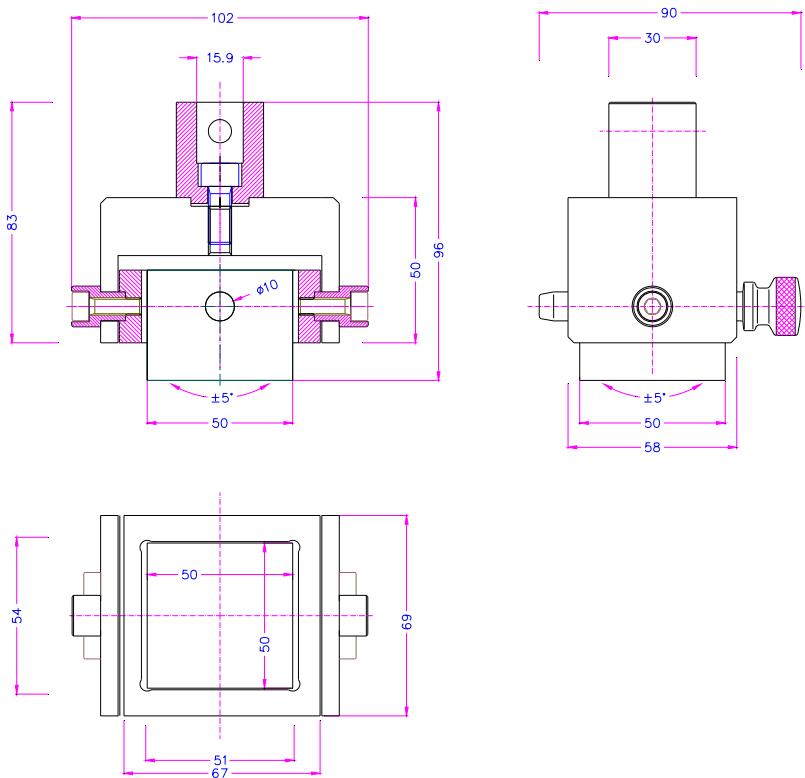

TH113-2Axe-GT + TH113-E50-50x50 EN1607

TH113-327 Type

Double-axis version - for larger samples from 100x100 mm

A test specimen is bonded between two rigid plates that are then pulled apart. Possible plate sizes include e.g. 100x100, 150x150, 200x200, 300x300 mm.

The fixture consists of:

1. 1 pair of cardan (universal) joint adapters (item no. THS327, see [THS327 Datasheet](#)),
2. 1 pair of connection adapters to connect the cardan joint adapter and plate, (item no. THS637 or THS646 depending on the plate size, see [THS637 Overview](#) and [THS646 Datasheet](#)),
3. 1 pair of rigid plates (item no. TH36, see [TH36 Datasheet](#)).

Standard coupling: Af159. Further couplings on request
 Cardan joint and connection adapters: Steel, nickel-plated
 Plates: Aluminium
 Temperature range: -70 ... +180°C
 Scope of delivery: Plates, cardan joint adapter and connection adapter have to be ordered separately.

ASTM C297	ASTM D3354	ASTM D1623B	EN 1607	EN 2243-4	DIN 53292	Plate size:
	x		x			100x100 mm
			x			150x150 mm
			x			200x200 mm
			x			300x300 mm

Example:

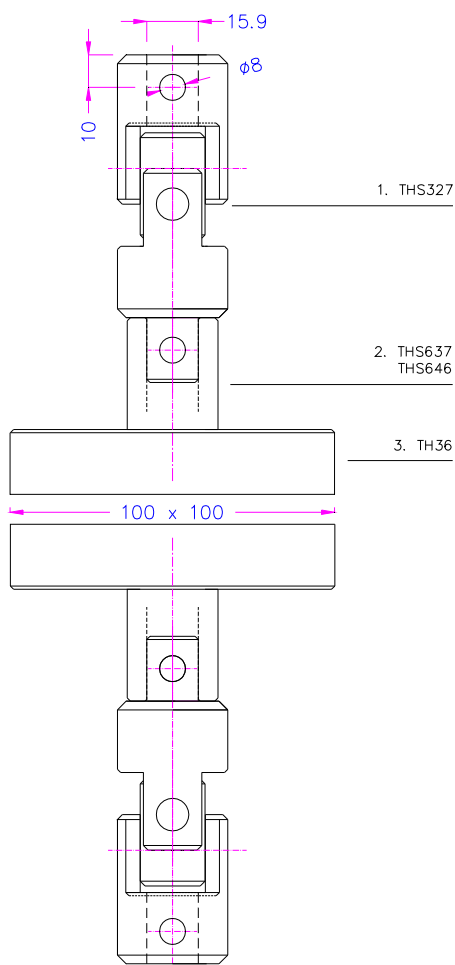

TH113-327-P100x100-Af159
 Fixture for tests according to ASTM D3354 and EN 1607 for samples 100x100 mm, coupling Af159 mm, weight 1.15 kg



TH113- 327-P100x100-Af159