

TH205

Pneumatic switches

**TH205-1 Foot switches**

Non-locking: The jaws of the grip open by pressing the foot pedal and close after removing the foot from the pedal. Only for single action rods with spring inside. Max. pressure 10 bar.
Scope of delivery: 1 pair of foot switches including tubes and fittings

**TH205-2 Foot switches**

With locking function: The jaws of the grip open by pressing the foot pedal and remain opened after removing the foot from the pedal. The jaws close by pressing the pedal one more time. Only for single action rods with spring inside. Max. pressure 10 bar.
Scope of delivery: 1 pair of foot switches including tubes and fittings

**TH205-8 Foot switches**

Like TH205-2, but with 5/2 directional valve.
For double action rods without spring returns. Max. pressure 10 bar.
Can be used with grips like THS321 or TH109...+Ko.
Scope of delivery: 1 pair of foot switches including tubes and fittings

**TH205-PR10bar Pressure regulator**

Optional for all versions.
To adjust air pressure: 1-10 bar

**TH205-3 Hand switches**

1 unit of pneumatic hand switches, tubes and fittings
With locking function
Only for single action rods with spring inside. Max. pressure 16 bar.
Scope of delivery: 1 unit of hand switches including tubes and fittings

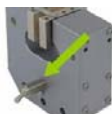
**TH205-4-M5 TH205-4-1/8" Hand switches**

Pneumatic micro – hand switches, tubes and fittings, M5 and 1/8" connections
With locking function: The hand switches are directly installed at the grips, 3/2 directional valve.
Only for single action rods with spring inside. Max. pressure 16 bar.
Scope of supply: 2 hand switches including tubes and fittings

**TH205-PR16bar Pressure regulator**

Optional for TH205-3, TH205-4-M5, TH205-4-1/8"
To adjust air pressure: 1-16 bar

**TH216 Silent compressor for laboratories, oil-lubricated, with pressure reducer**

Max pressure 16 bar; 230 V/50 HZ; noise level: 38 dB(A)
Motor: 0.13 kW; displacement: 17 l/min; tank size 3.5 l
Dimensions: 340x290x340 mm (L x W x H); weight 18 kg

www.grip.de/G12/TH205

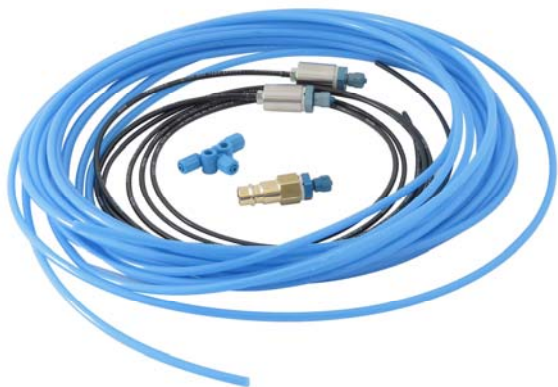

TH205-4

Scope of supply:

2 micro hand switches (1/8" or M5) + 2 tubes (3 mm and 2 mm inner Ø) + Tee connector + 2 adapters + 1 Euro plug (Ø 12 mm, hole 7,9 mm)



TH205-4 Tubes and fittings

+ Euro plug
(Ø 12 mm, hole 7,9 mm)



TH205-4-1/8 Hand switches

For the grips: TH149, TH83, TH232, TH108, THS65, THS132, TH56g+Ko, TH240g+Ko



TH205-4-M5 Hand switches

For the grips: TH229, TH56k+Ko, TH240k+Ko, THS13, THS22



TH205-4-1/8" + TH149 grip



TH205-4-M5 + TH229 grip

TH196-2-M5 Teflon tube for 280°C

High-temperature teflon tube for up to +280°C
Size PK2 (2 mm inner Ø)



Teflon tube for 280°C

We deliver one side of a teflon tube like these ready spigots when grips are ordered with high-temperature option

T180°C or T280°C options are available

Ferrule connection

TH205-PK23

Intermediate adapter from PK2 (2 mm) to PK3 (3 mm) for a quick and easy interchange of grips

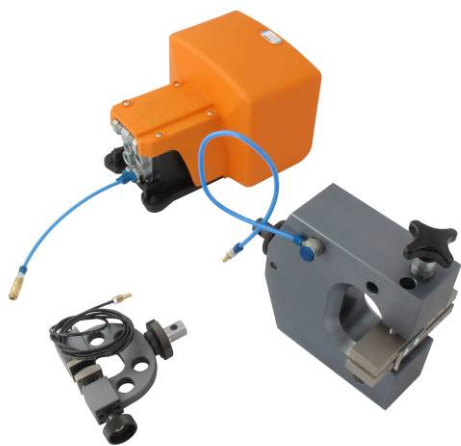

TH205-2 TH94 TH83 TH205-9



TH205-9 Mini plug
(total length plugged together: 30 mm, external Ø 10 mm, M5 thread)

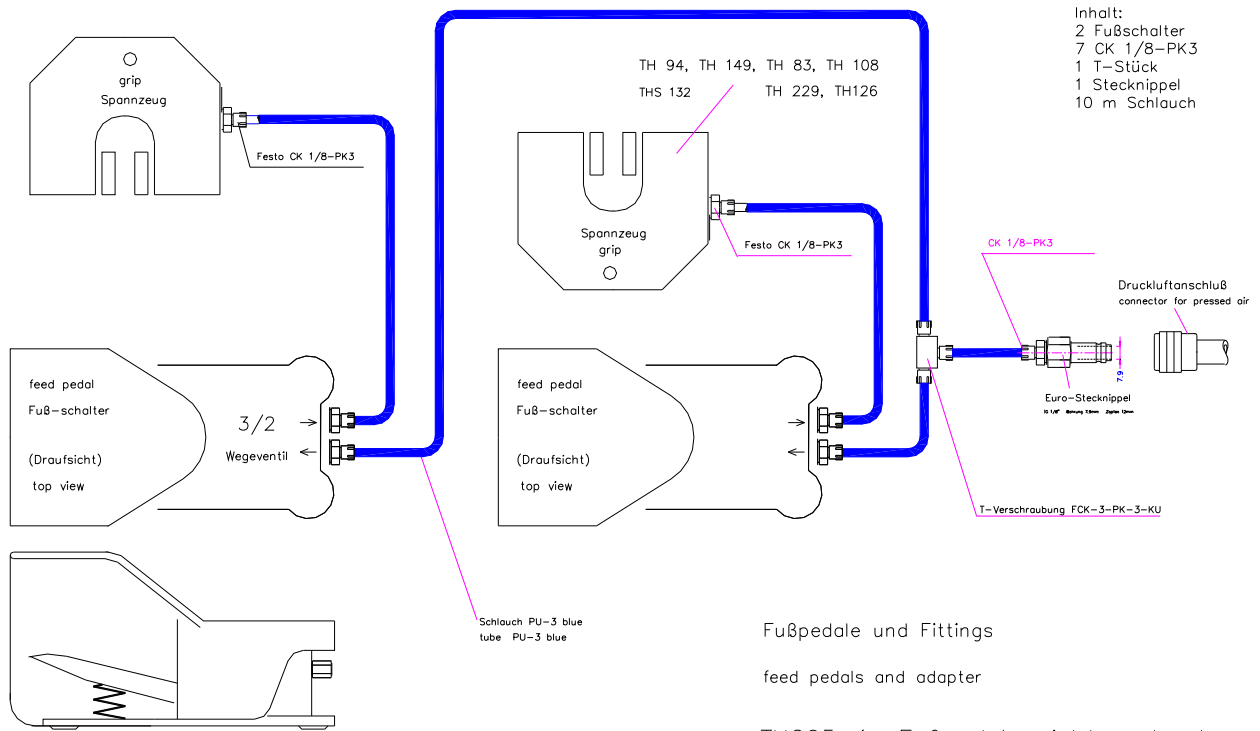

TH205-1 Fußpedale nicht rastend

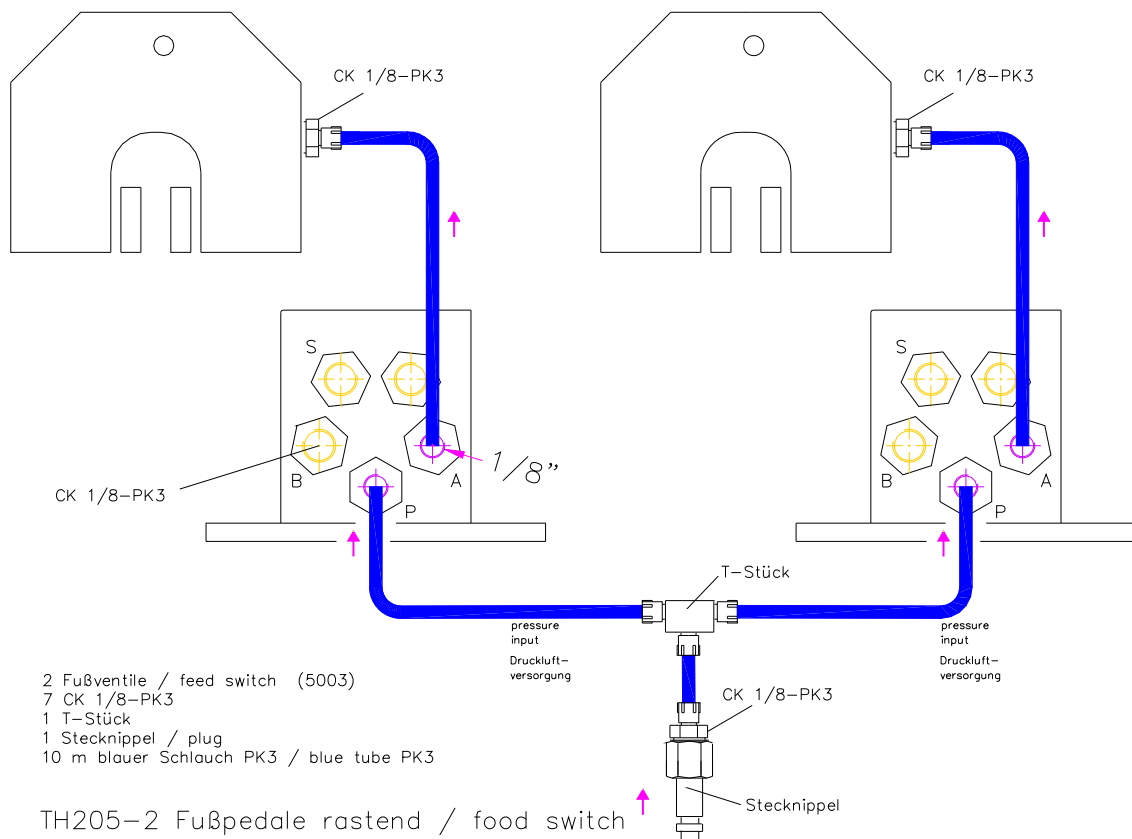

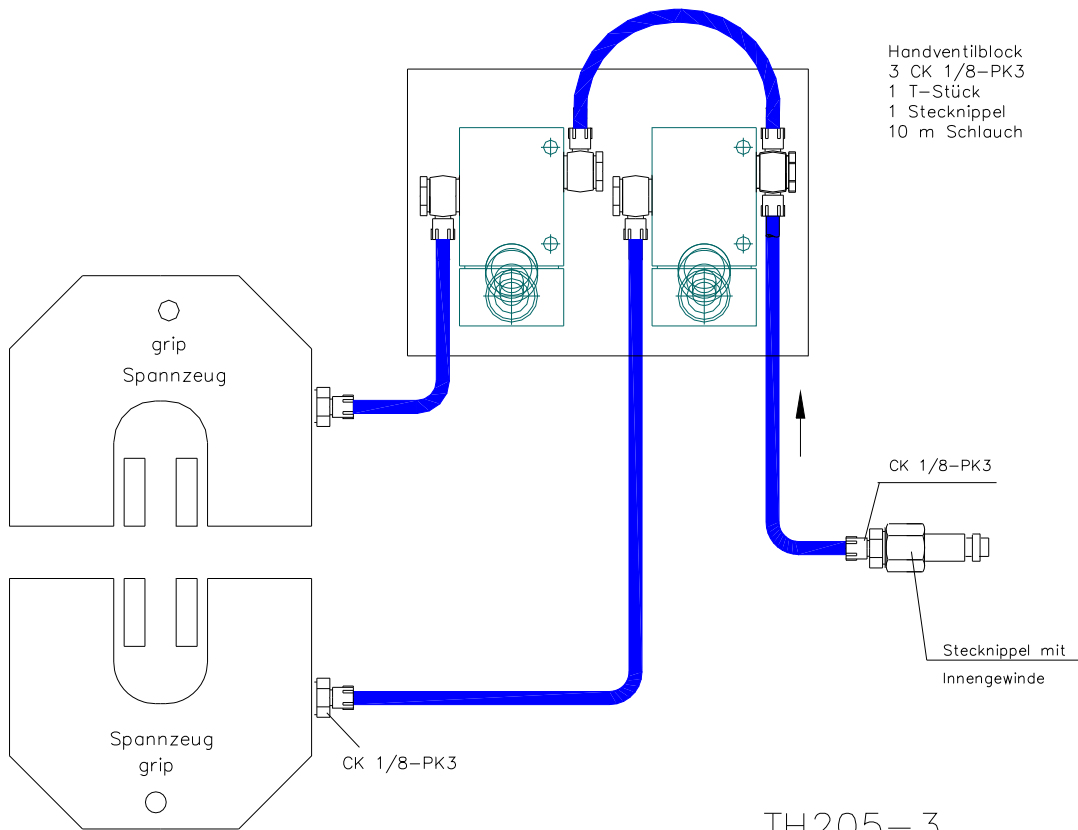

TH205-3

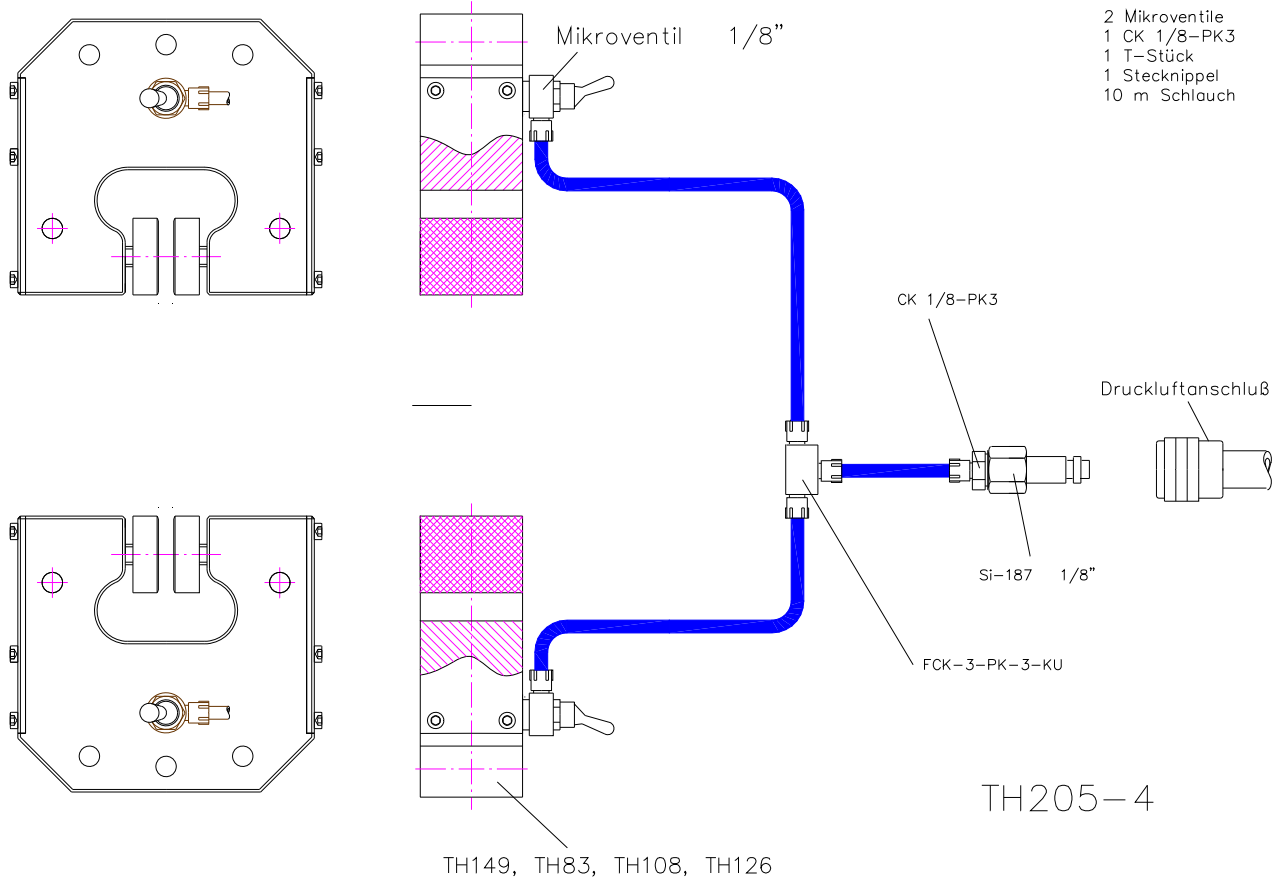

TH205-4

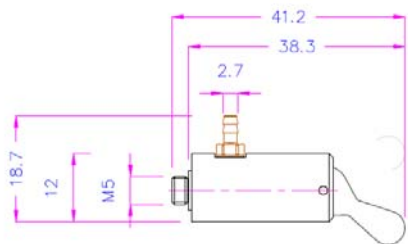

TH205-4-M5

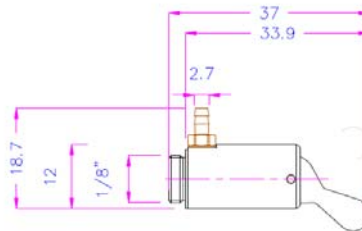

TH205-4-1/8"

The switches TH205-1, TH205-2, TH205-3- TH205-4 are 3/2 directional valve. They can be used with the following grips:

TH229, TH94, TH175 TH83, TH126m TH232, TS65, THS132, THS370, THS501, TH240...+Ko, TH56...+Ko THS341+Ko, TH149, THS22.

Grips with double-acting pistols (e.g. TH109-...+Ko, THS321) need the TH205-8 switches (5/2 directional valve).

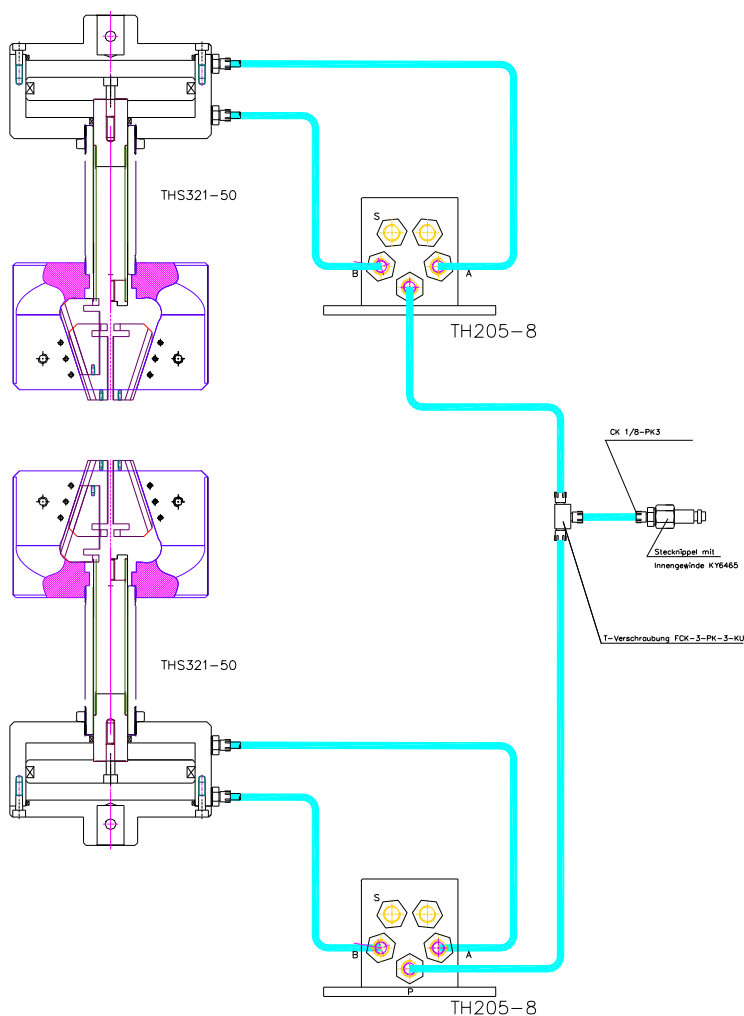

TH205-8-SP

Videos:

- http://youtu.be/MzuwM_zvLT4
- <http://youtu.be/AqtWTxeKVfK>

- TH205-2 Locking function
- How to adjust air pressure