

COMPRESSION SHEAR TEST FIXTURE

to evaluate glue bond of plywood according to DIN EN314-1

Item no.:	THS1112-EN314-1
Max. load:	10-20 kN
Opening:	25 mm
Body:	Steel, nickel-plated
Jaws:	Polyamide
Temperature range:	0 ... +70°C Further temperature ranges on request
Weight:	0.4 kg per fixture (without platens)
Scope of delivery:	1 fixture. Compression platens to be ordered separately (see page 2).

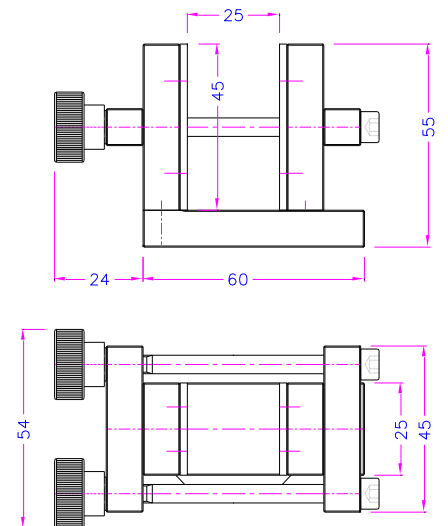
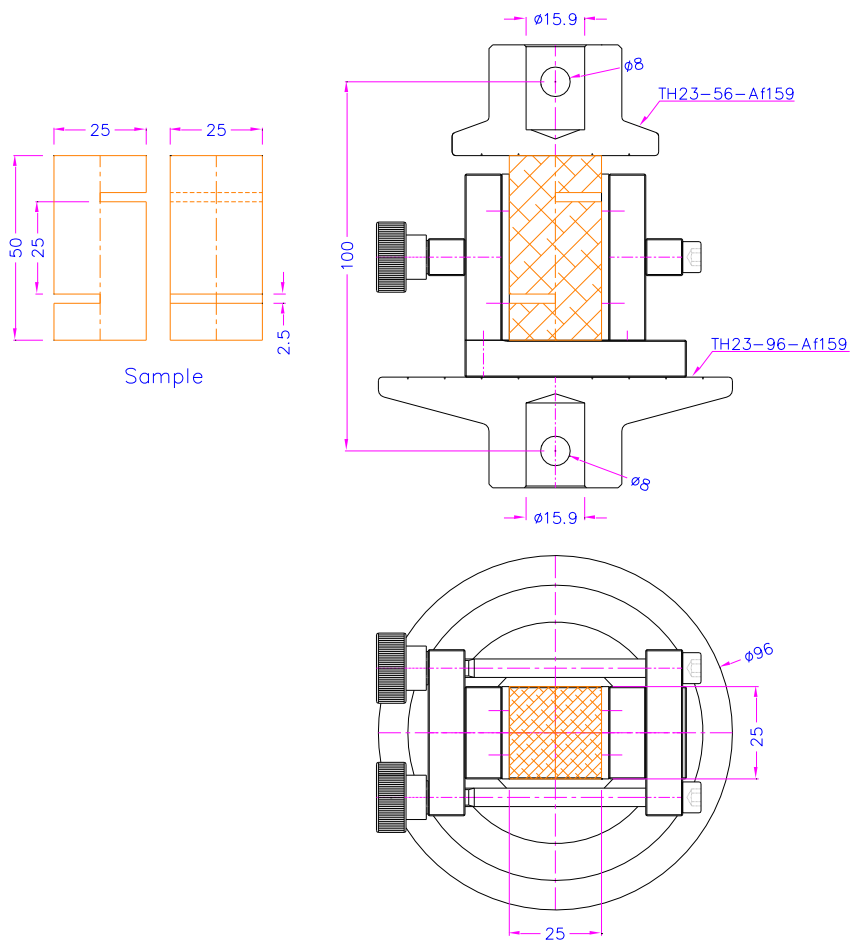

THS1112-EN314-1

We recommend TH23-56-St and TH23-96-St compression platens for upper and lower platens:

[TH23 Datasheet.pdf](#)



09.01.2026OI