

## PNEUMATIC GRIP 11 kN

THS65 grips are supplied in pairs, but can also be ordered as a single grip (0.5 pair).  
Grips and jaws need to be ordered separately.

<b>Item no.</b>	<b>THS65</b>
Clamping force:	11 kN at 7 bar
Temperature range:	0°C ... +70°C Further temperature ranges on request
Body:	Aluminum, anodized
Jaws:	58 HRC steel, manganese phosphate coating
Pneumatic connection:	1/8" inner thread
Weight:	5.6 kg per grip (incl. THS65-BW wave jaws)



**Jaws for THS65:** Scope of delivery: 1 set = 4 jaws

Item no.	Surface	Clamping surface H x W	Opening	Weight per pair
THS65-BP	Pyramid (serrated)	60 x 100 mm	0 - 30 mm*	2 kg
THS65-BW	Wave	60 x 100 mm	0 - 30 mm*	2 kg

**Pyramid (serrated) jaws**

- Pyramids 1.2x45°

**Wave jaws**

- For flexible materials
- 5 mm wave

\* Jaws with further openings and other dimensions and surfaces possible on request.

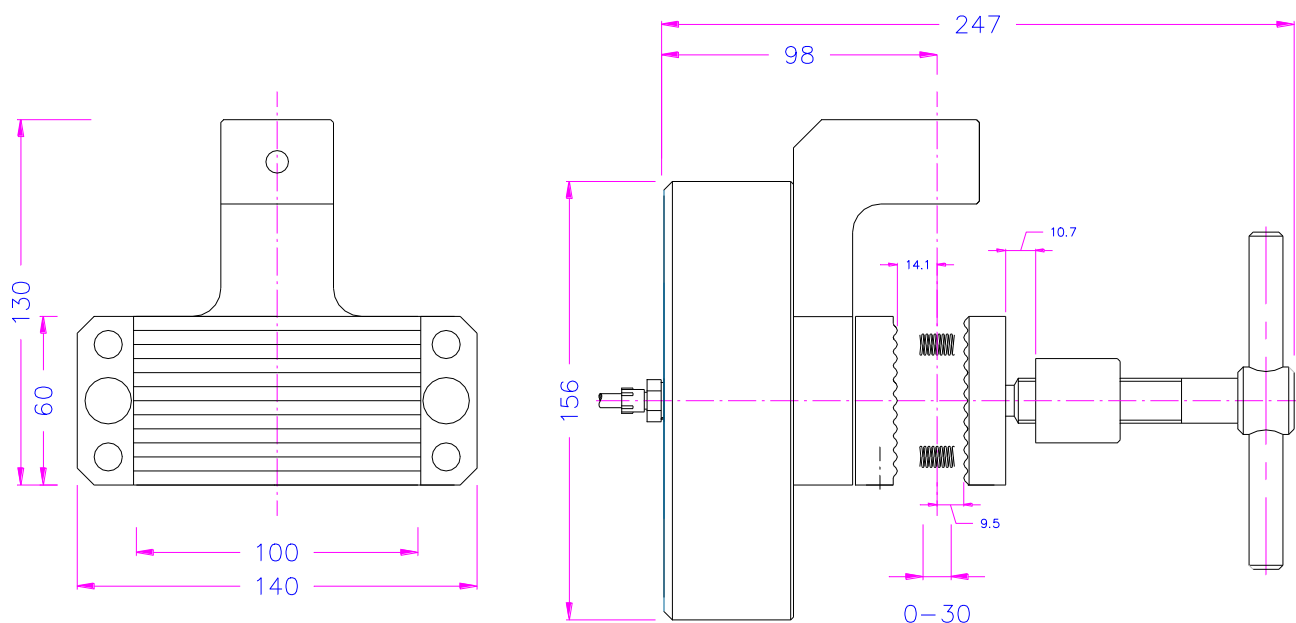

-> 11 kN (7bar) <-

THS65

## Pneumatic accessories:



### TH205-1 Foot pedals

None locking: The jaws of the grip open by pressing the foot pedal and close after removing the foot from the pedal.

Scope of delivery: 1 pair of foot switches including tubes and fittings



### TH205-2 Foot pedals

With locking function: The jaws of the grip open by pressing the foot pedal and remain opened after removing the foot from the pedal. The jaws close by pressing the pedal one more time.

Scope of delivery: 1 pair of foot switches including tubes and fittings



### TH205-PR10bar Pressure regulator

Optional for TH205-1 or TH205-2

To adjust air pressure: 1-10 bar

### TH205-PR16bar Pressure regulator

Optional for TH205-1 or TH205-2

To adjust air pressure: 1-16 bar



### TH205-3 Hand switches

With locking function: The jaws of the grip close by pulling the handle and remain closed. The jaws open by pushing the handle back.

Scope of delivery: 1 unit of hand switches including tubes and fittings

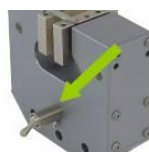

### TH205-4-1/8" Hand switches with 1/8" connection

With locking function (see TH205-3)

The hand switches are directly mounted at the grips. 3/2 directional valve

Scope of supply: 2 hand switches including tubes and fittings

If ordered together with grips, hand switches will be mounted directly on the grips.



### TH216 Silent compressor for laboratories, oil-lubricated, with pressure reducer

Max pressure 16 bar; 230 V/50 Hz; noise level: 38 dB(A)

Motor: 0.13 kW; displacement: 17 l/min; tank size 3.5 l

Dimensions: 340x290x340 mm (L x W x H); weight 18 kg