

SHEAR PUNCH FIXTURES

to test shear strength of plastics by punch tool according to ASTM-D732.
 The fixture is placed on a compression platen.
 The punch tool is pushed through the fixture to cut a 1" (25.4 mm) Ø disk from the specimen.

Item no.:	THS712-20-ASTM-D732
Max. load	20 kN
Standard coupling:	Af15.9 or Af20 mm For further coupling sizes please see THS712-10-ASTM-D732 (p. 2)
Body:	Steel, nickel-plated
Standard temperature range:	0° ... +70°C. Further temperature ranges on request
Weight per fixture:	Ca. 4 kg
Scope of delivery:	1 fixture. Lower compression platen is needed for the test (not included in the price)

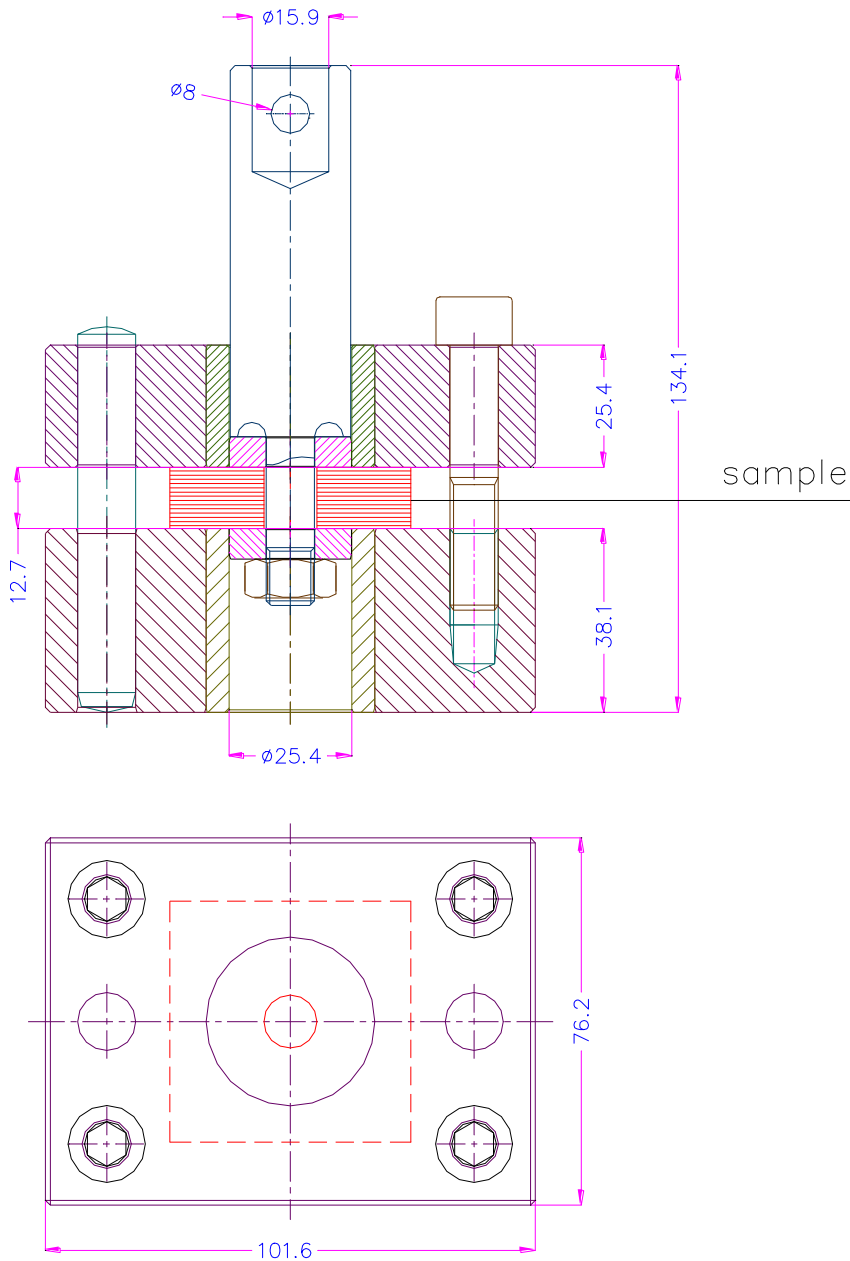

Item no.: THS712-10-ASTM-D732

Identical to THS712-20-ASTM-D732, but the punch has no coupling, max. load 100 kN.

Lower and upper compression platens are needed for the test (not included in the price).

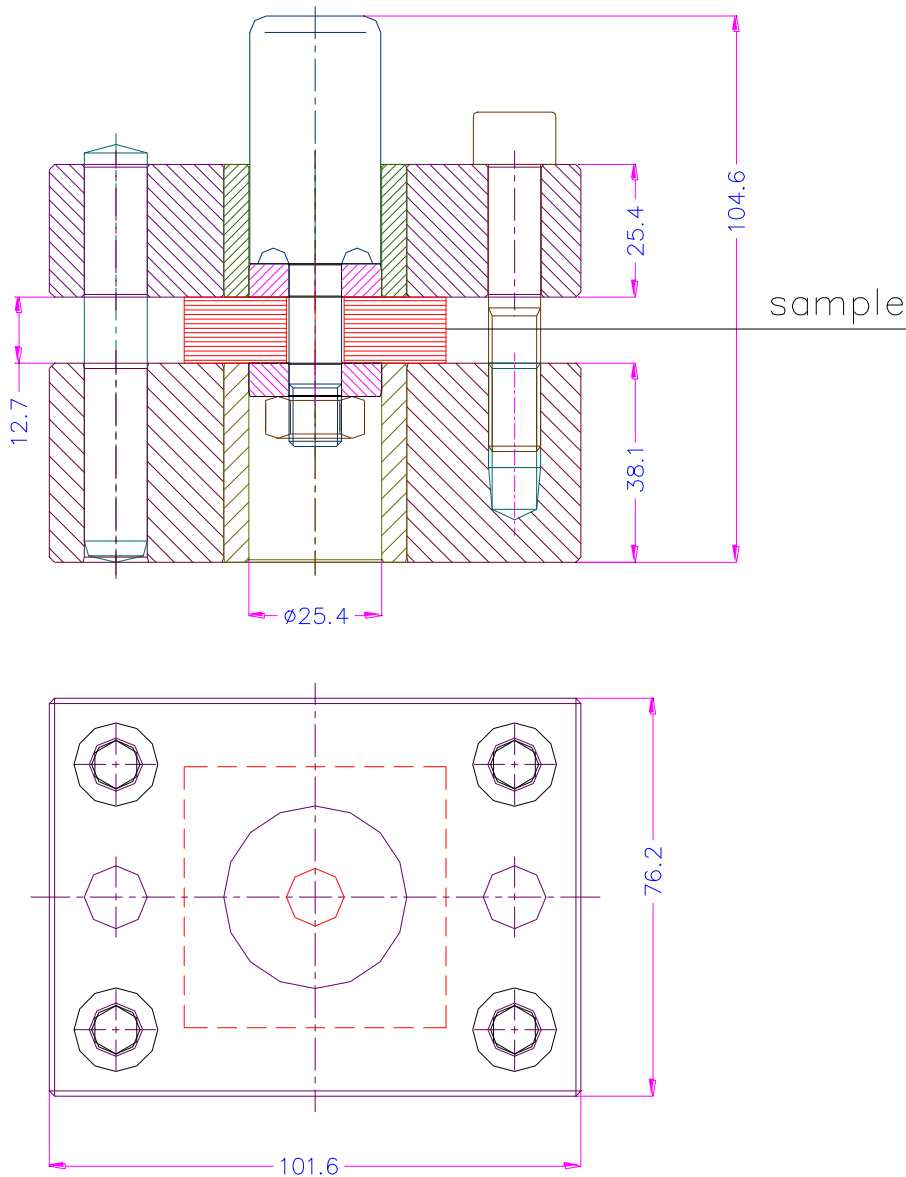

We recommend TH23 compression platens to use with THS712:



See <http://www.grip.de/G01/TH23/>