

COMPRESSION PLATENS

Aluminium compression platens are used to test soft samples such as cardboards, soft plastics, etc. Steel compression platens are applicable for hard materials e.g. steel, hard plastics, stone etc. Perforated compression platens are suitable for testing of foam materials.

Item no:	TH36-AxB-C-AL (aluminium platens) TH36-AxB-C-ST (steel platens) TH36L-AxB-C-L-AL (perforated platens)	A = short side B = long side C = adapter size AL = aluminium ST = steel L = holes to let the air out
Standard coupling:	Female [mm]: Ø 15.9 (5/8"), 20, 30, 31.8 (10/8"), 32, 36, 40 Male [mm]: Ø 31.7 Further couplings on request	
Max. load:	Depends on coupling size and platen material	
Material:	Aluminium, anodized. Steel, hardened, nickel-plated	
Temperature range:	-70...+ 180°C (aluminium); -70...+280°C (steel) Further temperature ranges on request	
Scope of supply:	1 pair of platens incl. adapter with a standard coupling	

Aluminium platens

Item number	Dimensions	Weight/ platen
TH36-50-AL	50 x 50 mm	0.1 kg
TH36-100-AL	100 x 100 mm	0.51 kg
TH36-120-AL	120 x 120 mm	0.75 kg
TH36-120x180-AL	120 x 180 mm	1.13 kg
TH36-125x250-AL	125 x 250 mm	1.62 kg
TH36-150-AL	150 x 150 mm	1.17 kg
TH36-150x300-AL	150 x 300 mm	2.28 kg
TH36-200-AL	200 x 200 mm	2.10 kg
TH36-200x300-AL	200 x 300 mm	3.39 kg
TH36-250-AL	250 x 250 mm	3.19 kg
TH36-300-AL	300 x 300 mm	4.35 kg
TH36-350-AL	350 x 350 mm	6.60 kg
TH36-400-AL	400 x 400 mm	8.70 kg

Further dimensions and modifications on request

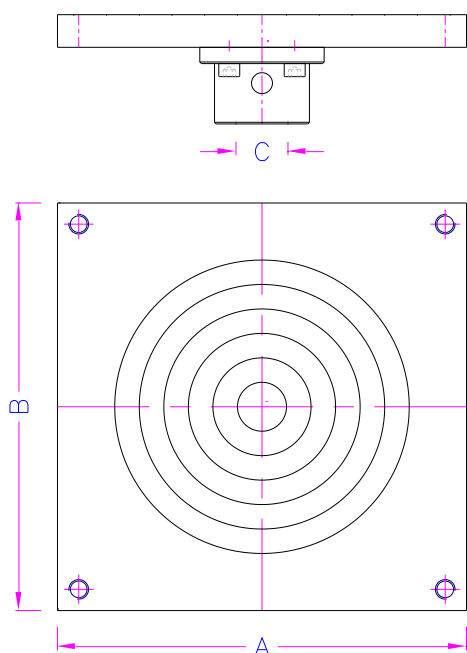

Steel platens

Item number	Dimensions	Weight/ platen
TH36-100-ST	100 x 100 mm	1.54 kg
TH36-196-ST	196 x 196 mm	6.60 kg
TH36-200-ST	200 x 200 mm	7.10 kg
TH36-246-ST	246 x 246 mm	10.40 kg
TH36-296-ST	296 x 296 mm	13.60 kg
TH36-396-ST	396 x 396 mm	33.00 kg



TH36-250-AL



TH36-100-ST

Perforated platens

6 mm Ø holes spaced at 20 mm

Item number	Dimensions	Weight/each platen
TH36L-100-L6x20-AL	100 x 100 mm	0.48 kg
TH36L-120-L6x20-AL	120 x 120 mm	0.68 kg
TH36L-150-L6x20-AL	150 x 150 mm	1.10 kg
TH36L-150x220-L6x20-AL	150 x 220 mm	1.63 kg
TH36L-200-L6x20-AL	200 x 200 mm	1.95 kg
TH36L-300-L6x20-AL	300 x 300 mm	4.29 kg
TH36L-390-L6x20-AL	390 x 390 mm	7.43 kg
TH36L-400-L6x20-AL	400 x 400 mm	8.20 kg



TH36L-200-L6x20-AL

Further dimensions and modifications on request

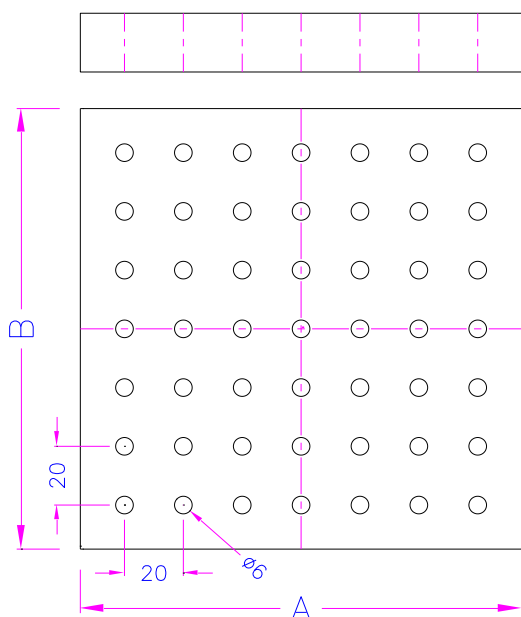

TH36L-D200-L6x20-AL

Examples for further modifications:

	<p>Combination:</p> <p>TH36-250-AL + THS223k-250x250-AL</p> <p>(self-aligning, spherically seated compression platen, see also THS223)</p>
	<p>TH36-D200-R1 + THS223b-Af159 - DIN EN ISO2439</p> <p>Compression platen with ball joint to measure the indentation hardness of flexible cellular materials according to DIN EN ISO2439 Diameter 200 mm, radius 1 mm</p> <p>For bottom platen we recommend TH36L-400-L6x20-AL</p>