

CARPET AND FLOOR COVERING TEST FIXTURES



THS1067-10-ISO4919

Fixture to test tuft withdrawal force of carpets according to ISO4919

Max. load:	150 N
Carpet thickness:	2-9 mm
Coupling:	Af159. Further couplings on request
Material:	Steel, nickel-plated
Temperature range:	0 ...+70°C Further temperature ranges on request
Scope of delivery:	Bottom sample holder, hook and forceps



Hook for testing loop pile carpets



Forceps for testing cut pile carpets



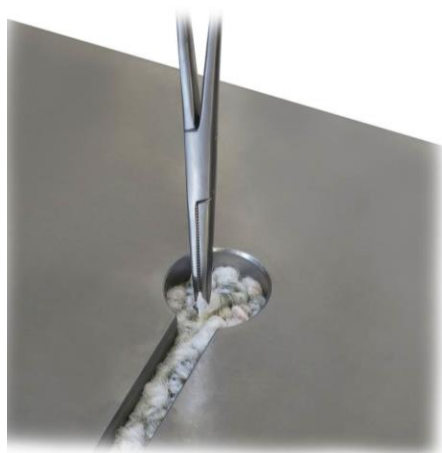
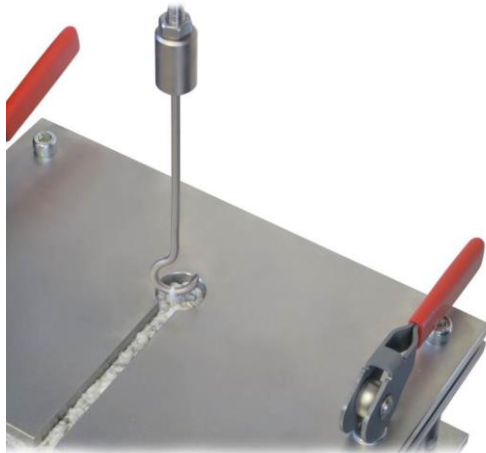
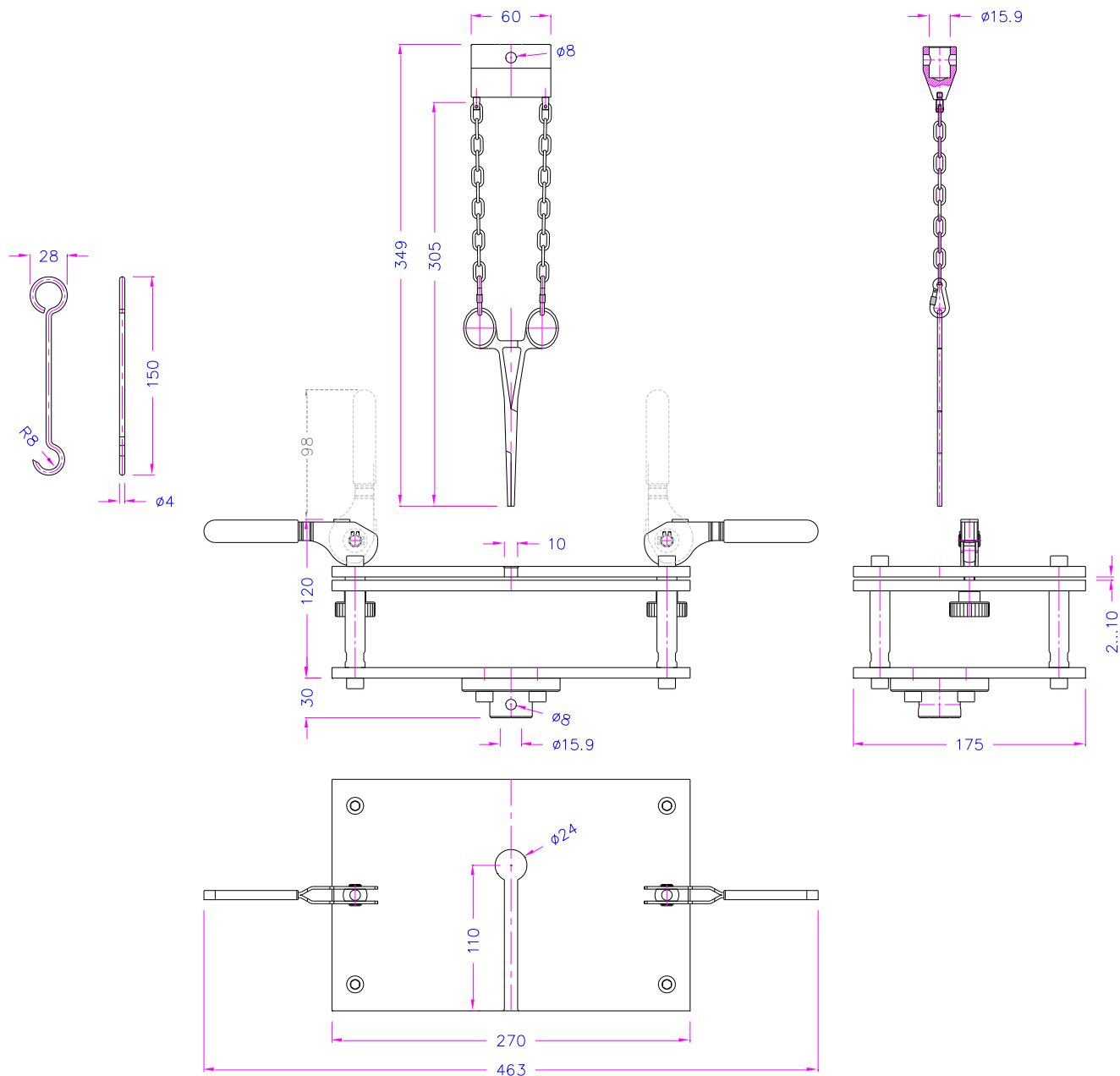

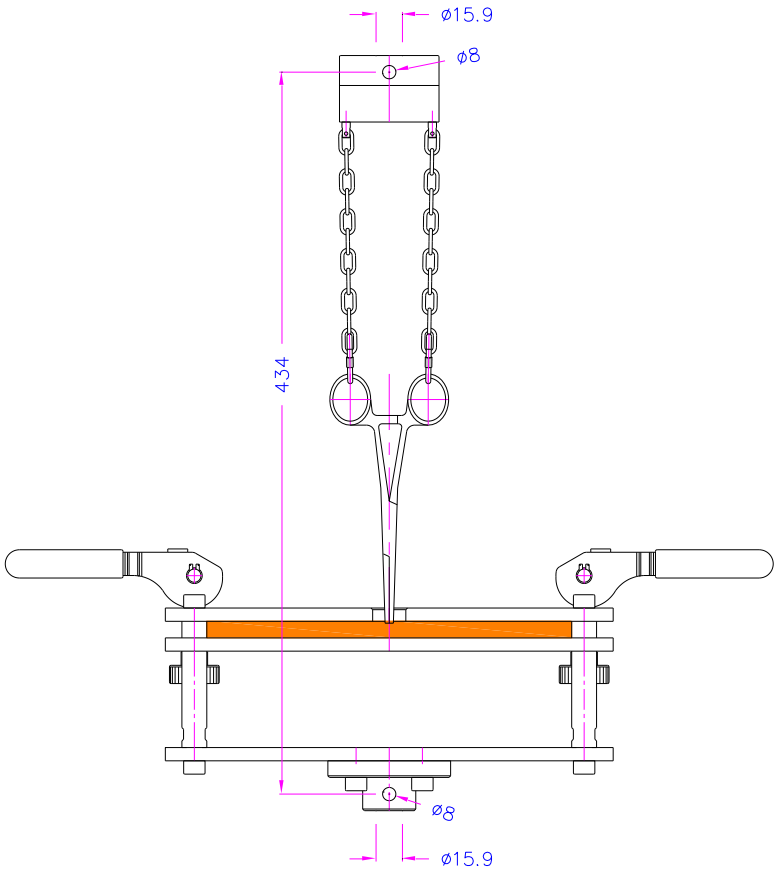
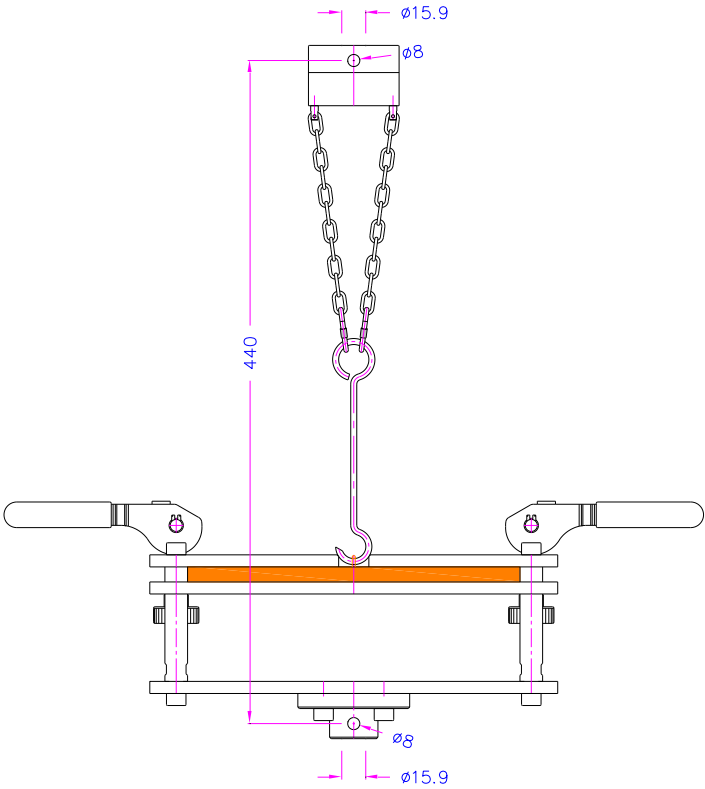



THS1067-20-40x50-ASTM-D1335

Fixture to test tuft withdrawal force of carpets according to ASTM-D1335

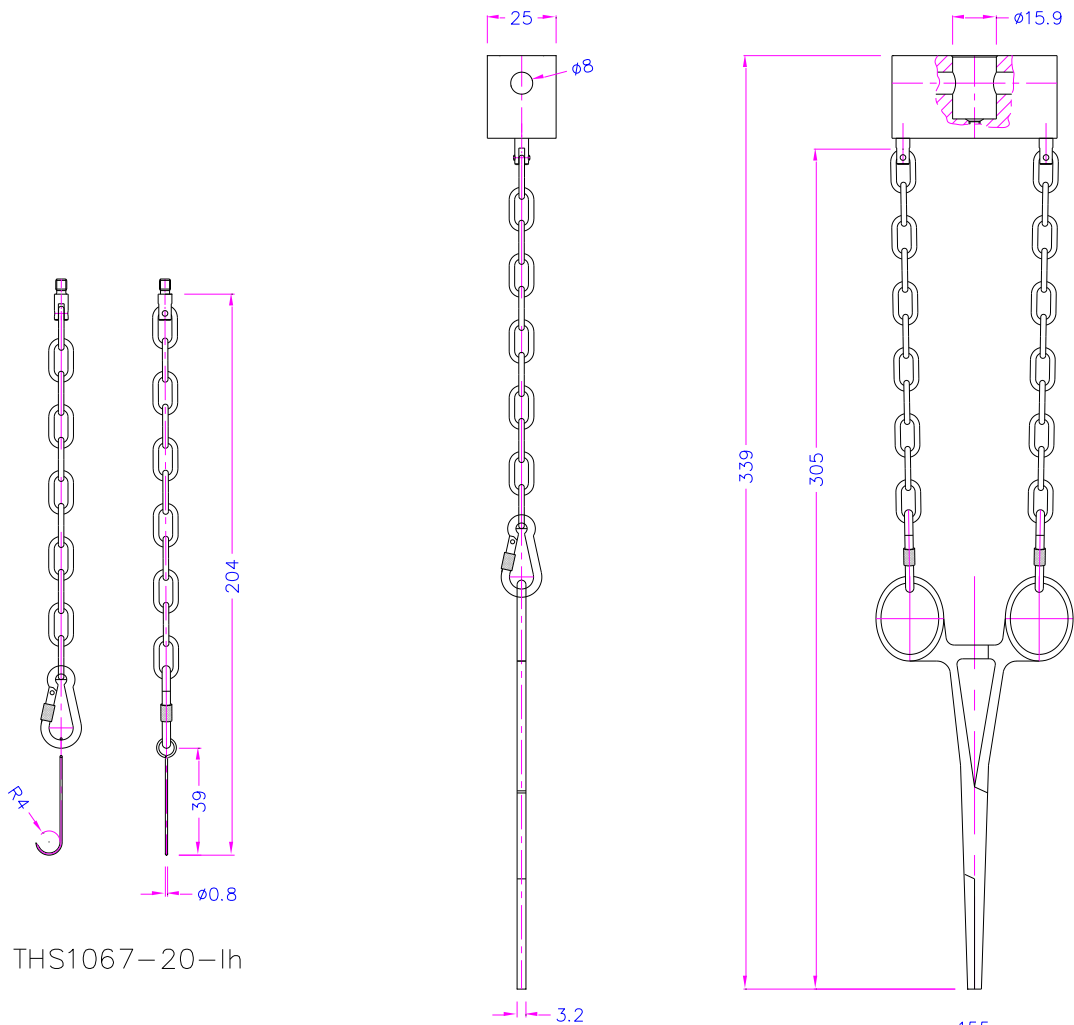
Max. load:	150 N
Carpet thickness:	0-6 mm
Clamping jaws:	Wave jaws. 30x80 mm (H x W)
Roller:	40 mm Ø. 150 mm long, 50 mm cut-out.
Coupling:	Af159. Further couplings on request
Material:	Steel, nickel-plated
Temperature range:	0 ...+70°C Further temperature ranges on request
Scope of delivery:	Bottom sample holder, hook and forceps

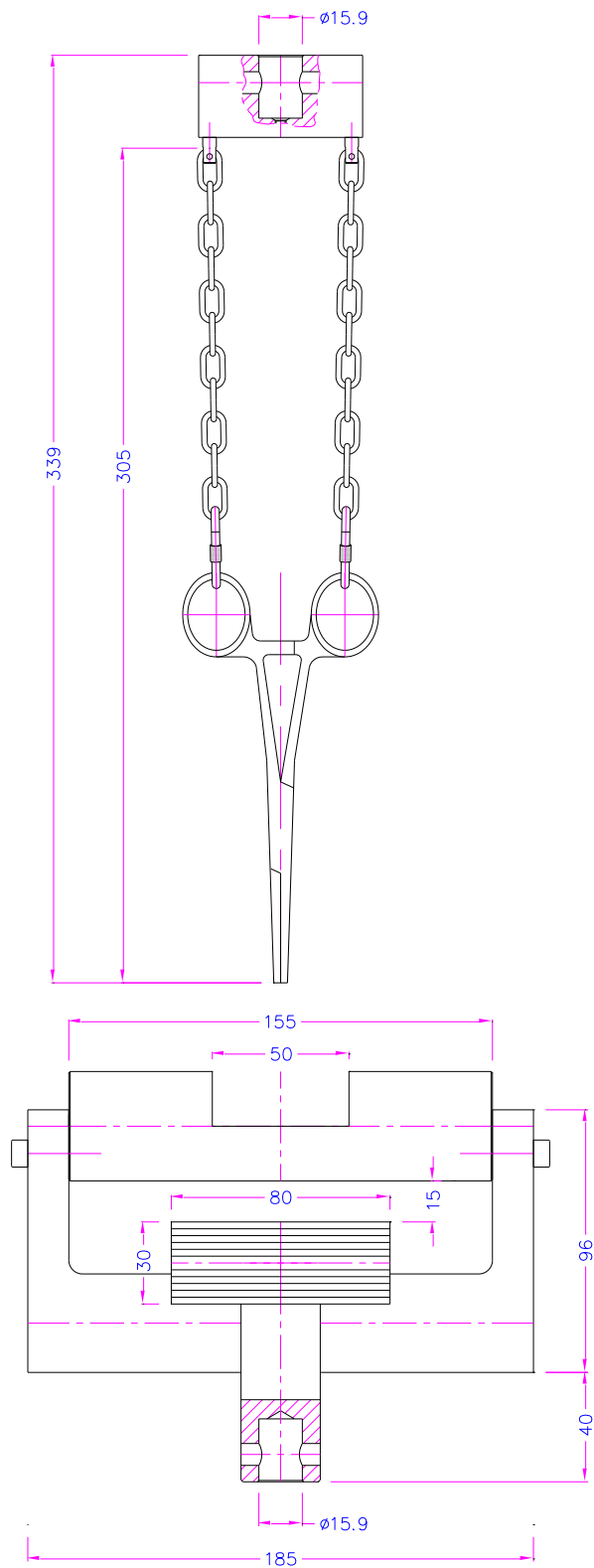
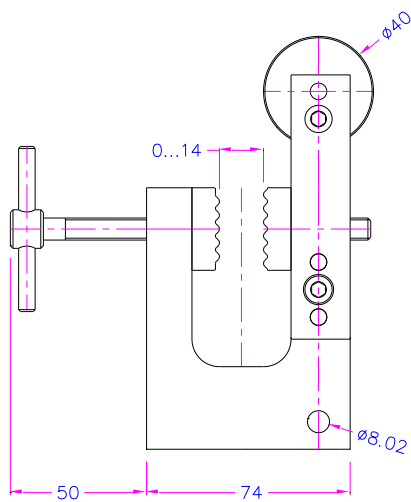

THS1067-20-lh



THS1067-20 with a sample

