

TRANSVERSE RUPTURE FIXTURE

to test cemented carbides according to ISO3327 and ASTM-B406.

The fixture is placed between 2 compression platens mounted in a tensile tester.

Carbide cylinders (supports) are placed into the fixture.

The sample is placed onto the supports.

Plunger is pushed down onto the specimen until it ruptures the specimen.



Item no.:	THS1087-30-ASTM-B406 THS1087-30-ISO3327-TypeA+B THS1087-30-ISO3327-TypeC
------------------	---

Max. load:	50 kN
Weight:	3.33 kg per fixture incl. plunger
Material:	Steel, nickel-plated (body) Steel, hardened, nickel-plated (plunger) Carbide (balls and cylinders)
Temperature range:	-10 ... +80°C Further temperature ranges on request
Scope of supply:	1 fixture. Top and bottom compression fixtures are required for the test (must be ordered separately)

THS1087-30-ASTM-B406 according to ASTM-B406, for flat samples:

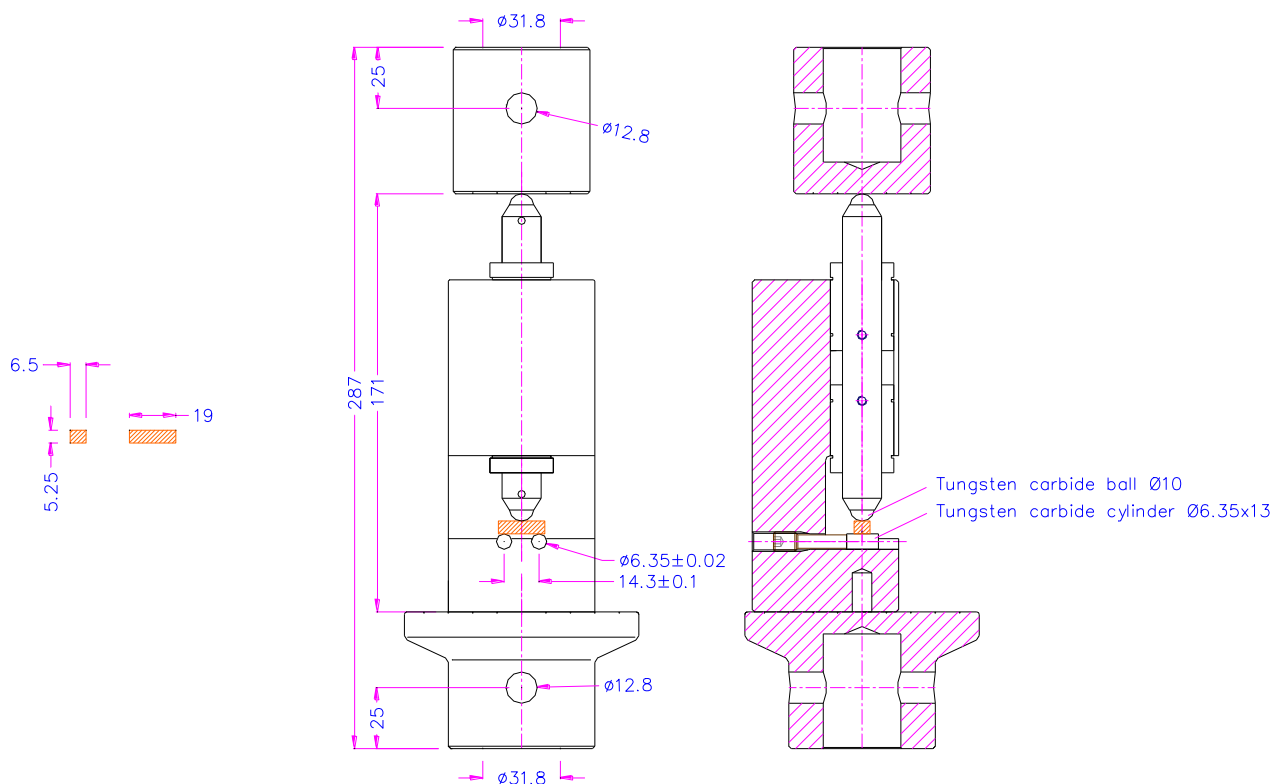

THS1087-30-ISO3327-TypeA+B according to ISO3327 Types A and B, for flat samples:

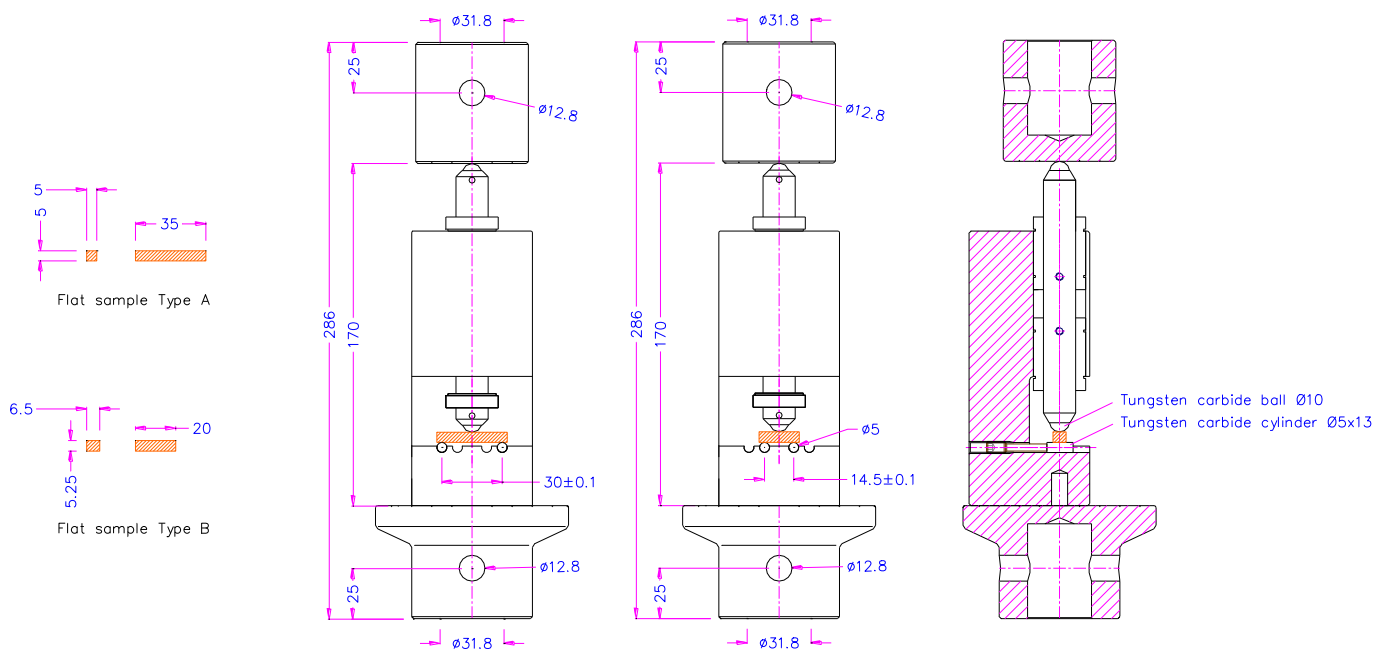

THS1087-30-ISO3327-TypeC according to ISO3327 Type C, for cylindrical samples:

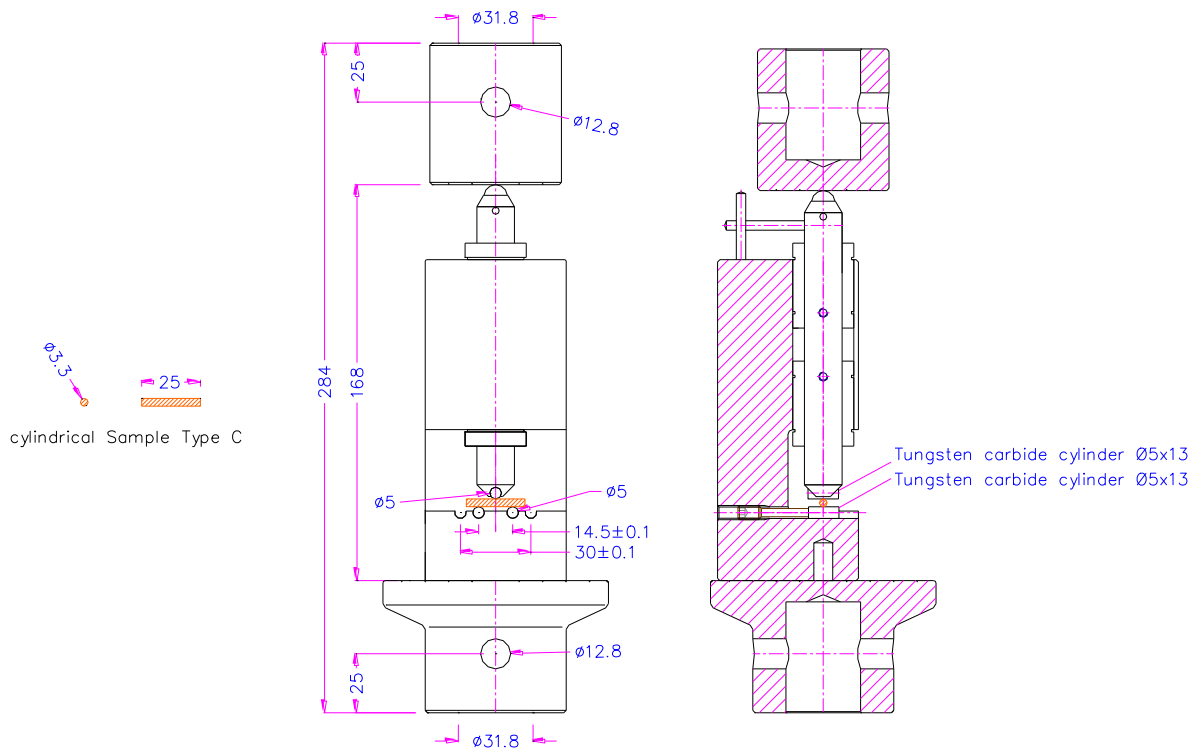

Recommendation for compression platens:**Top compression platen**

Item no.: TH23-56-St-Af318

Steel, hardened, nickel coated
56 mm Ø
Coupling Af318

**Bottom compression platen**

Item no.: TH23-96-St-Af318

Steel, hardened, nickel coated
96 mm Ø
Coupling Af318

[TH23 data sheet.pdf](#)