

## WEDGE GRIP

<b>Item no.:</b>	<b>THS622</b>
Tensile force:	10 kN
Coupling:	Af159 or Af20 Further couplings on request
Temperature range:	0 ... +70°C Further temperature ranges on request
Body:	Steel, nickel-plated
Weight:	2.23 kg per grip incl. jaws
Scope of supply:	1 pair of grips

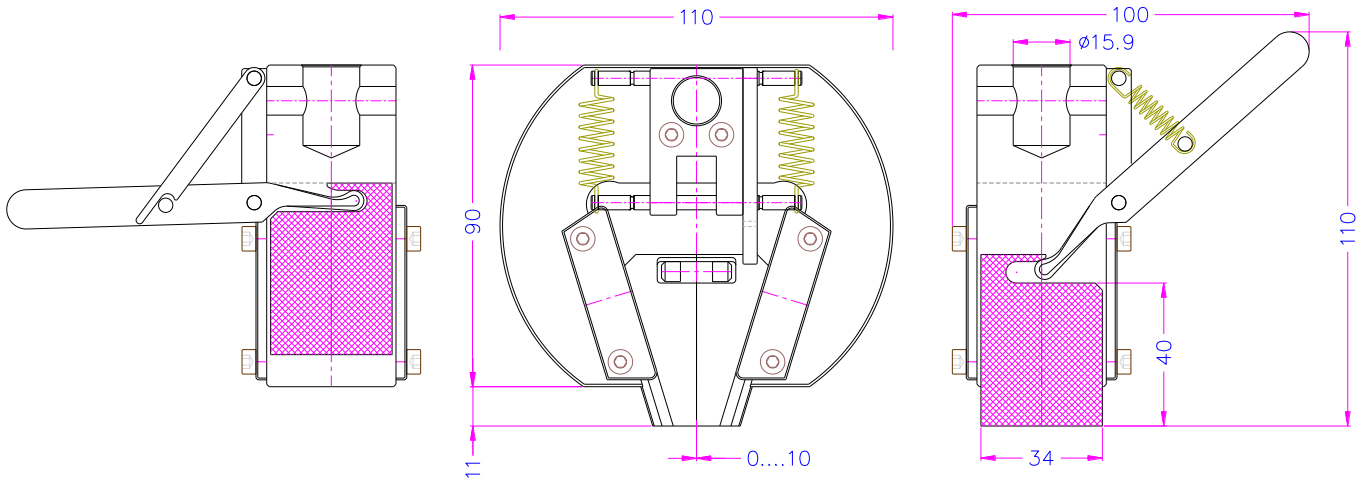

**Jaws for THS622**

Scope of delivery: 1 set = 4 jaws

Item no.	Surface	Clamping surface HxW	Opening	Weight per pair
THS622-BP	Pyramid (serrated) jaws	40x34 mm	0-10 mm	0.42 kg
THS622-BP16	Pyramid (serrated) jaws	40x34 mm	6-16 mm	0.39 kg
THS622-BP-W50	Pyramid (serrated) jaws	40x50 mm	0-10 mm	0.57 kg
THS622-BP16-W50	Pyramid (serrated) jaws	40x50 mm	6-16 mm	0.48 kg
THS622-BZ	Sawtooth jaws	40x34 mm	0-10 mm	0.42 kg
THS622-BV	V-jaws	Clamping height 40 mm	2-10 mm Ø	0.43 kg

Jaw faces with differing dimensions and surfaces available on request.  
Pyramid jaws are not applicable for steel specimens.



THS622-BV

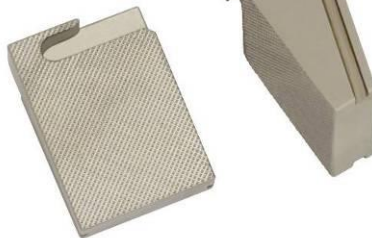

THS622-BP



**THS622-BP:**  
Pyramids 1x45°  
hardened steel



**THS622-BV:**  
Tooth pitch 1.2 mm  
hardened steel



THS622-BZ



**THS622-BZ:**  
Tooth pitch 1.25 mm  
hardened steel



Video <https://youtu.be/otz4FoBN-E>

Locking function