

TENSILE TEST FIXTURE

to measure longitudinal tensile properties of "Fiberglass"
(glass-fiber-reinforced thermosetting-resin) pipes and tubes
according to ASTM D2105

Item no.:	THS922-A-B-ASTM-D2105
	A = sample internal diameter, mm B = coupling
Max. load:	Depends on coupling
Body:	Steel, nickel-plated
Temperature range:	0° ... +70°C
Weight:	28 kg per pair (with coupling Af318)
Scope of delivery:	1 pair



Example:

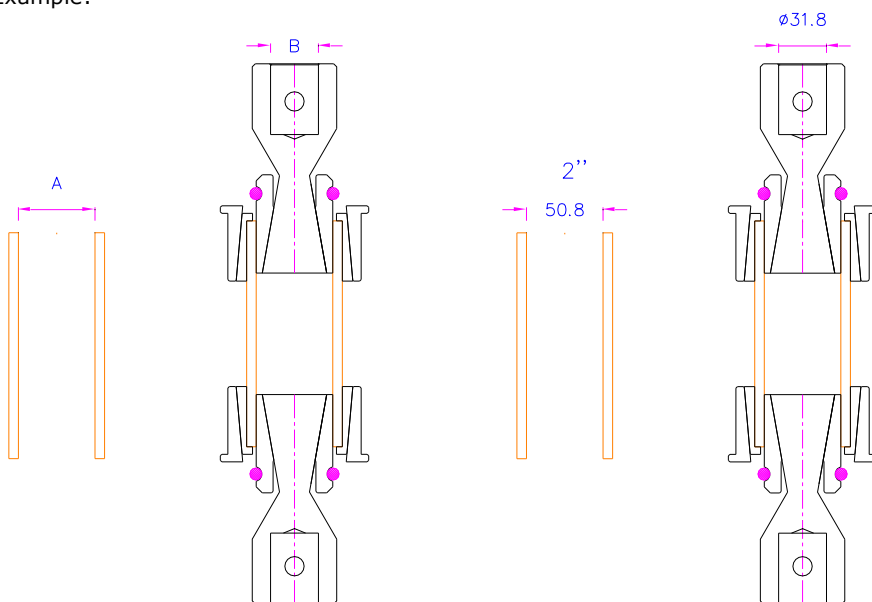

THS922-A-B-ASTM-D2105

THS922-50.8-Af318-ASTM-D2105



VIDEO

[Installation guide for THS922 fixture](#)

